



94 Pike Street, Suite 36
 Seattle WA 98101
 p: 206.682.1100
 f: 206.682.1300

CONSULTANT:

CLIENT:

CITY OF SEATTLE

STAMP:

PROJECT:
 COTTAGE GROVE PARK

SUBMITTAL:
 PLAYGROUND IMPROVEMENTS

PROJECT #: 08-090

DESIGNED BY: CC

DRAWN BY: AT

CHECKED BY: CC

ORIGINAL DATE: 10/29/2008

#	REVISION	DATE

SHEET TITLE:
 SITE PLAN

SHEET #:

L1.01

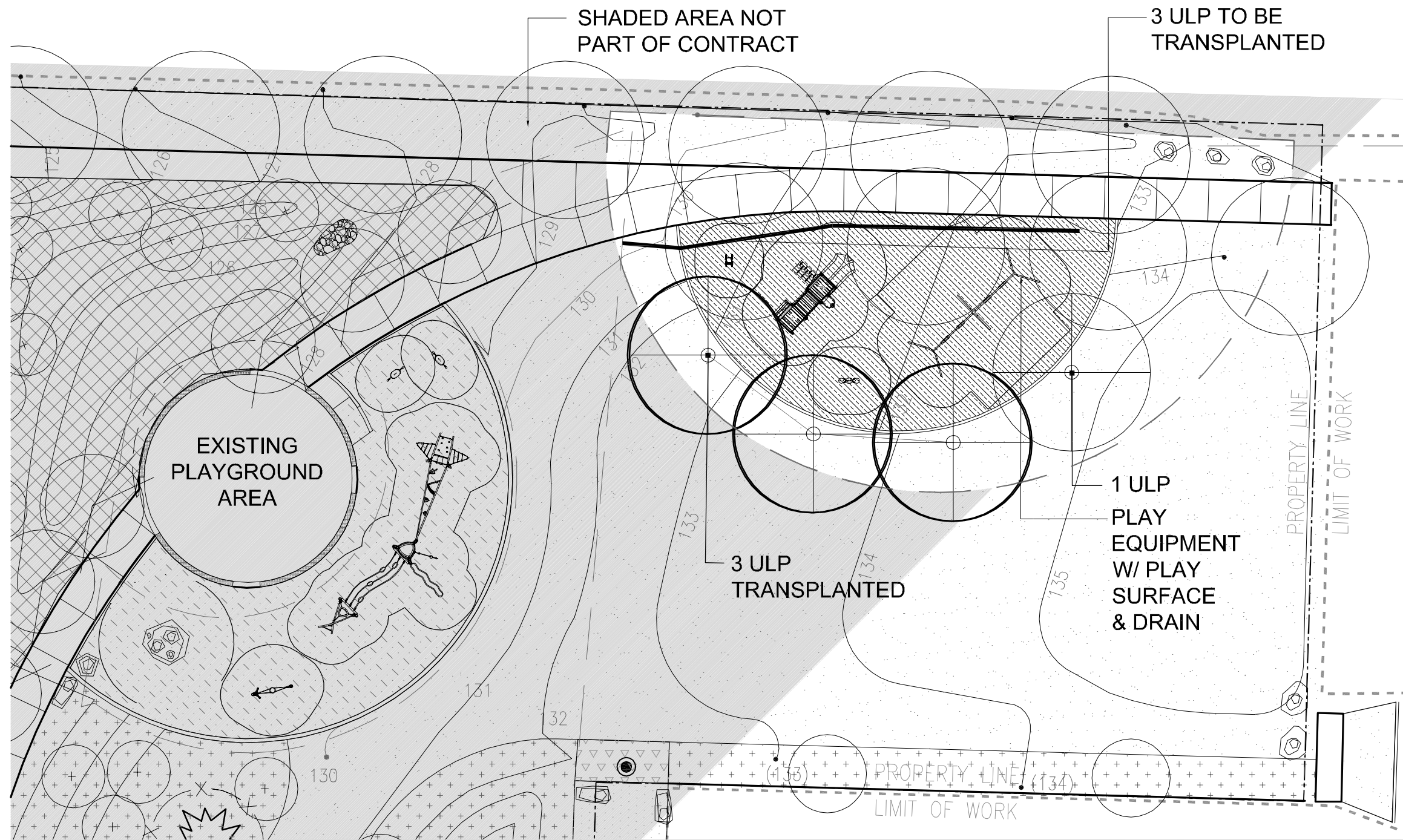

PLANT SCHEDULE - PER INSTALLATION OF ADDITIONAL TOT-LOT

SYMBOL	KEY	BOTANICAL NAME	COMMON NAME	SIZE	SPACING	QUANTITY
--------	-----	----------------	-------------	------	---------	----------

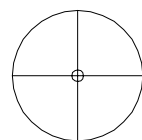

ULP	Ulmus parvifolia 'Prospector'	Prospector Elm	2" cal. B&B	AS SHOWN	1
-----	-------------------------------	----------------	-------------	----------	---

NOTE: THE (3) ULP TREES TO BE TRANSPLANTED SHALL BE RELOCATED 3' OFF THE BACK OF THE PLAYGROUND EDGE/CURB AND AN ADDITIONAL (1) ULP SHALL BE PLANTED AT THE MOST EASTERN EDGE OF THE TOT-LOT.

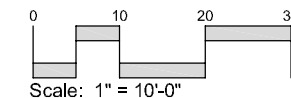

CALL WASHINGTON UTILITIES
 COORDINATING COUNCIL
 1.800.424.5555
 CALL 2- BUSINESS DAYS IN ADVANCE BEFORE YOU DIG,
 GRADE, OR EXCAVATE FOR THE MARKING OF
 UNDERGROUND MEMBER UTILITIES.