

D A V I D
VANDERVORT
ARCHITECTS
AIA

206.784.1614
vandervort.com

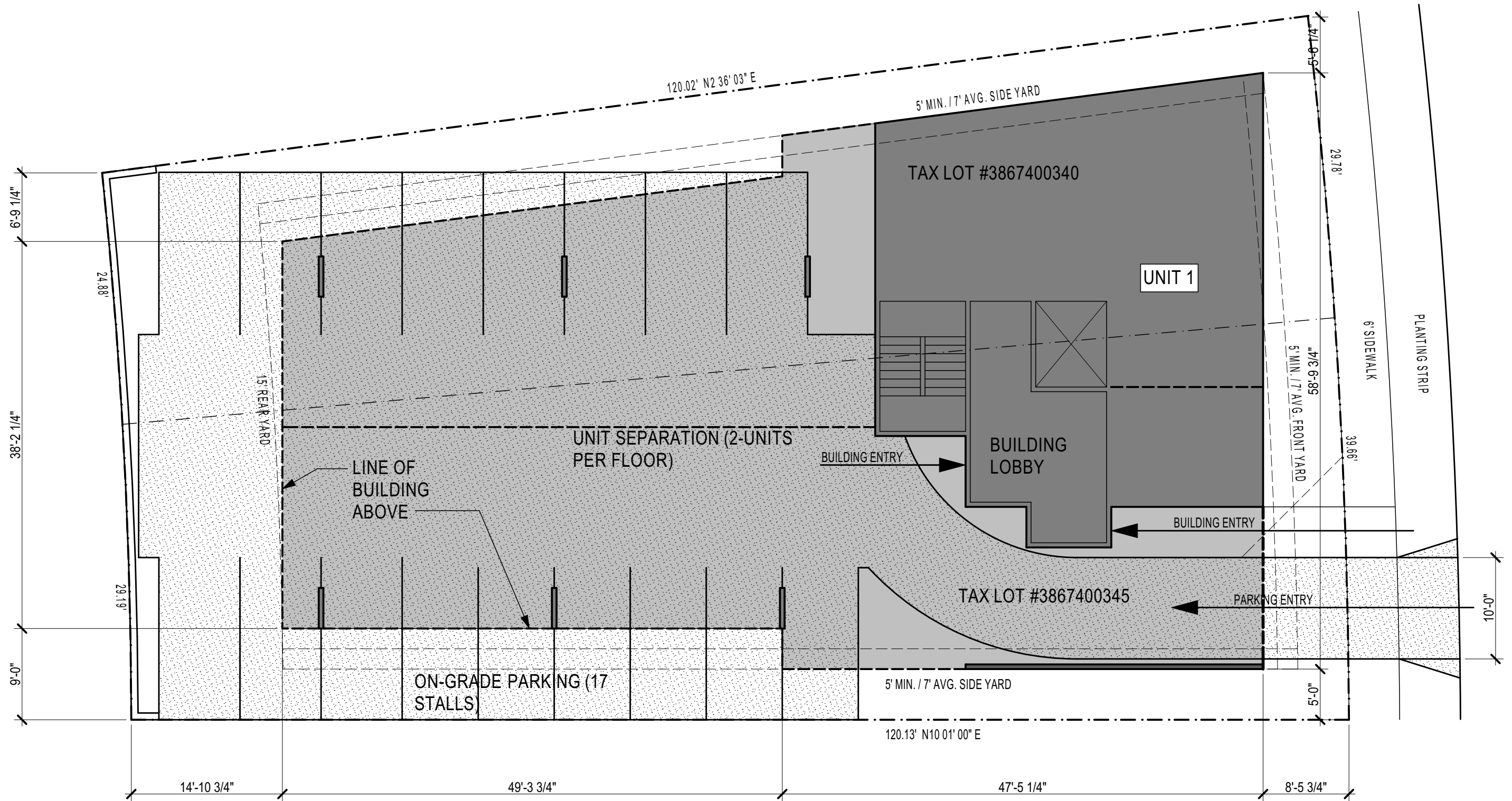

1118 & 1122 ALKI AVENUE SW - APARTMENT BUILDING

1" = 10'

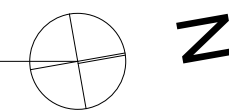

PROJECT DESCRIPTION:

DEMOLISH EXISTING 760 SF AND 1,000 SF SINGLE FAMILY RESIDENCES. CONSTRUCTION 6-STORY CONDOMINIUM STRUCTURE COMPRISING 11 LIVING UNITS WITH ON-GRADE PARKING FOR 17 VEHICLES.

PROJECT ADDRESS:

1118 & 1122 ALKI AVE SW
SEATTLE, WA 98116

PROJECT BUYER:

ATTOLLO DEVELOPMENT - JAY KENNEDY
10900 NE 8TH ST. SUITE 1000
BELLEVUE, WA 98101

TPN: 3867400345 & 3867400340

LEGAL: LOTS 36 & 37, BLOCK 2, KING ADD ADD.
DPD PROJECT #: 6510595

1118 / 1122
ALKI AVE SW
CONDOMINIUM
1 2 / 2 2 / 2 0 1 5

001