

# CONSTRUCTION NOTICE

## Road Improvements Coming Soon!

Corson Ave S, S Bailey St,  
& S Michigan St



### WEST SEATTLE BRIDGE PROGRAM

In March 2020, the Seattle Department of Transportation (SDOT) closed the West Seattle High-Rise Bridge to traffic in the interest of public safety due to the accelerated growth of new and existing structural cracks. Shortly after, we launched Reconnect West Seattle to support neighborhoods impacted by the closure — providing improvements to calm traffic and improve pedestrian mobility and neighborhood livability.

Learn about an upcoming improvement for your neighborhood inside.



PRSR1 STD  
US Postage  
PAID  
Seattle, WA  
Permit No. 2871

Seattle  
Department of  
Transportation  
PO Box 34996  
Seattle, WA 98124-4996

# Intersection Improvements coming to Corson Ave S, S Bailey St, and S Michigan St

The intersections of Corson Ave S, S Bailey St, and S Michigan Street will be undergoing several intersection improvements and traffic calming measures to improve driving conditions and pedestrian access.

These improvements include fully rebuilding slip lanes (a type of turn lane) on the northwest corner of S Michigan St and Corson Ave S, consolidating westbound lanes on S Bailey St, expanding crosswalk on the south end of the intersection of South Michigan St and Corson Ave, and a new raised crosswalk on the north side of that intersection. Going northbound on that intersection, the right turn will be converted to “no right on red”, the stop bar will be relocated, and a driveway and tree will be removed.

**WHAT TO EXPECT DURING CONSTRUCTION**

- Work will begin after the bridge reopening, and last approximately 3-4 weeks, weather permitting.
- Work will occur between 9 AM – 3 PM.
- Traffic may be flagged to a single lane at times, as needed.
- Parking may not be allowed during construction.
- We will notify neighbors of temporary driveway closures during the work.
- Typical construction equipment, materials, noise, dust, and activity in the work area.

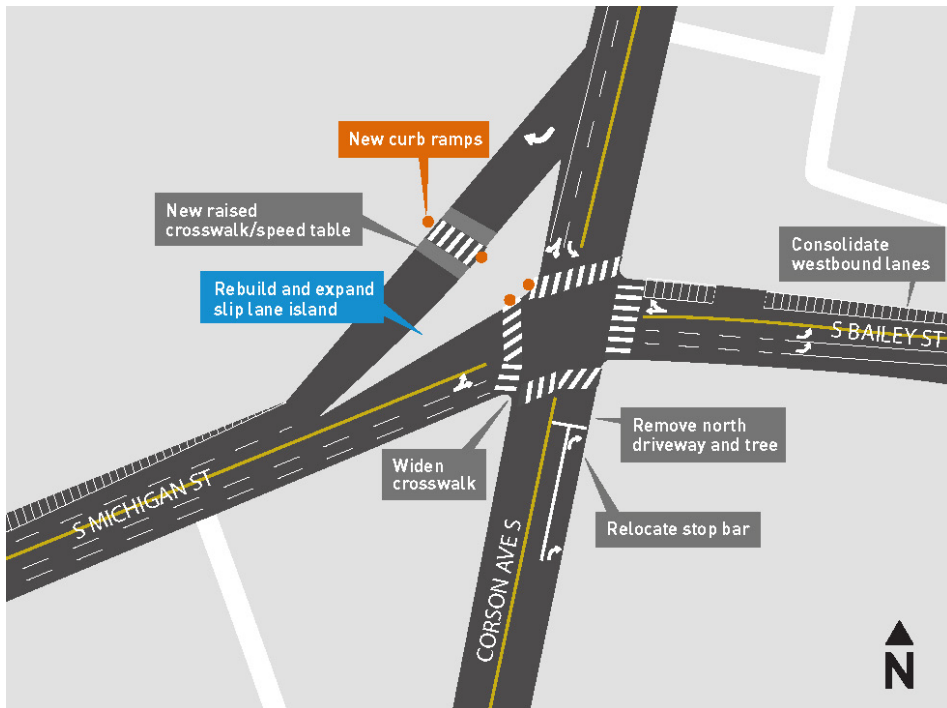

Exact timing of construction is highly dependent upon our crew’s availability, concrete procurement, and weather. Construction may be on a weekend or weekday.

Work hours are approximately 9 AM to 3 PM.

To learn more about this and other Reconnect West Seattle improvements, please visit [www.seattle.gov/ReconnectWestSeattle](http://www.seattle.gov/ReconnectWestSeattle).

Translation and Interpretation services available upon request: (206) 400-7511.  
 Dịch và thông dịch sẵn sàng nếu có sự yêu cầu (206) 400-7511.  
 Servicios de traducción e interpretación disponibles bajo petición (206) 400-7511.  
 Turjubaanka waxaa lagu heli karaa codsasho a (206) 400-7511.  
 요청하시면 번역이나 통역을 제공해드립니다 (206) 400-7511.  
 如果您需要此信息翻譯成中文 請致電 (206) 400-7511.  
 Tagalog mangyari lamang na tumawag sa (206) 400-7511.  
 የዚህን መረጃ ትርጉም ከፈለጉ፣ በዚህ ስልክ ቁጥር ይደውሉ፡ (206) 400-7511.  
 សំរាប់ការបកប្រែនិងការបកប្រែភាសាមានតាមការស្នើសុំតាមរយៈលេខ : (២០៦) ៤០០-៧៥១១.

**CONTACT**  
[WestSeattleBridge@seattle.gov](mailto:WestSeattleBridge@seattle.gov)  
 (206) 400-7511

